

LEVEL 2

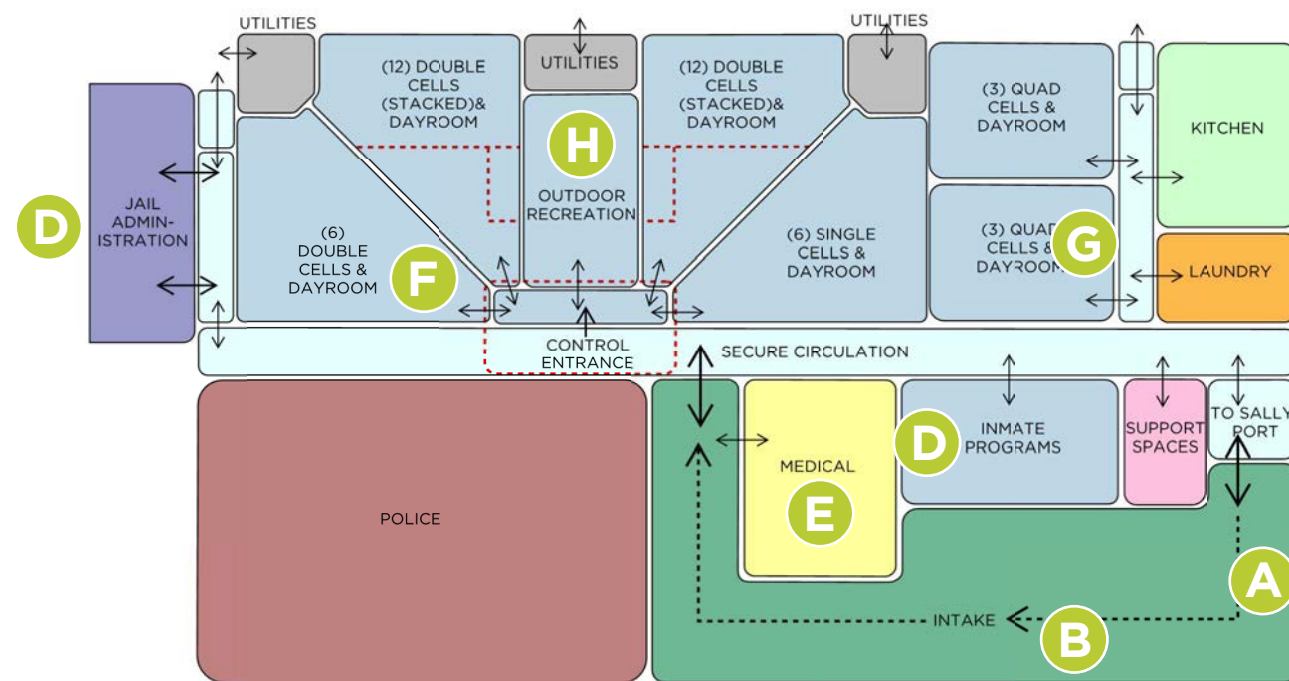

LEVEL 1

JAIL ADJACENCY DIAGRAM

- A** | Modern Booking
- B** | Expanded Safety Cells
- C** | Direct Oversight
- D** | Programming Space
- E** | Medical Services
- F** | Expanded Housing Capacity
- G** | Outdoor Recreation
- H** | Expanded Classifications

POLICE ADJACENCY DIAGRAM

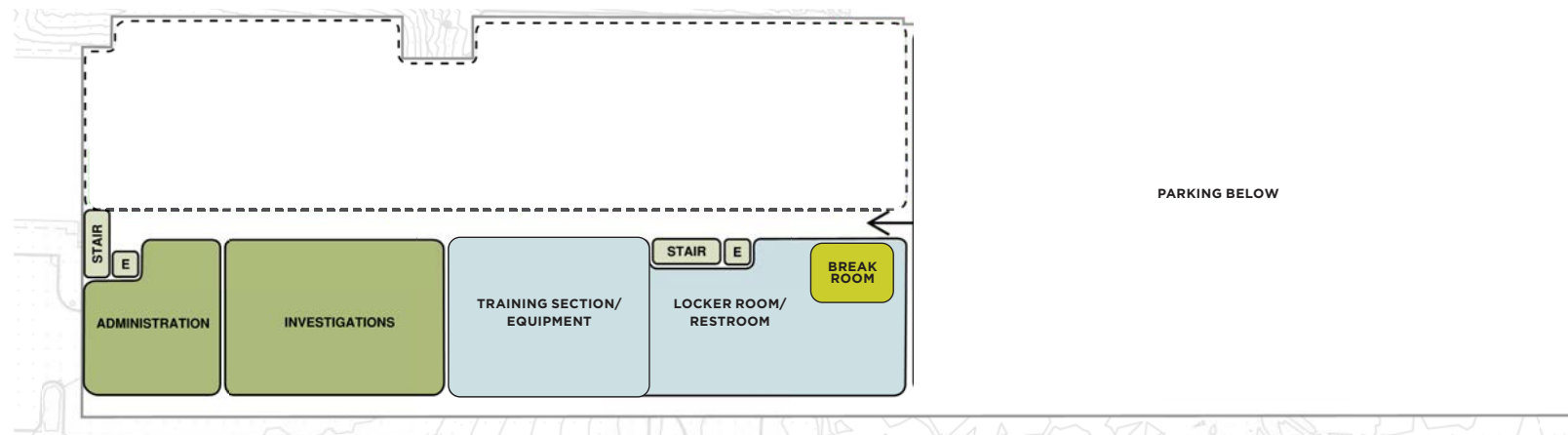

LEVEL 3

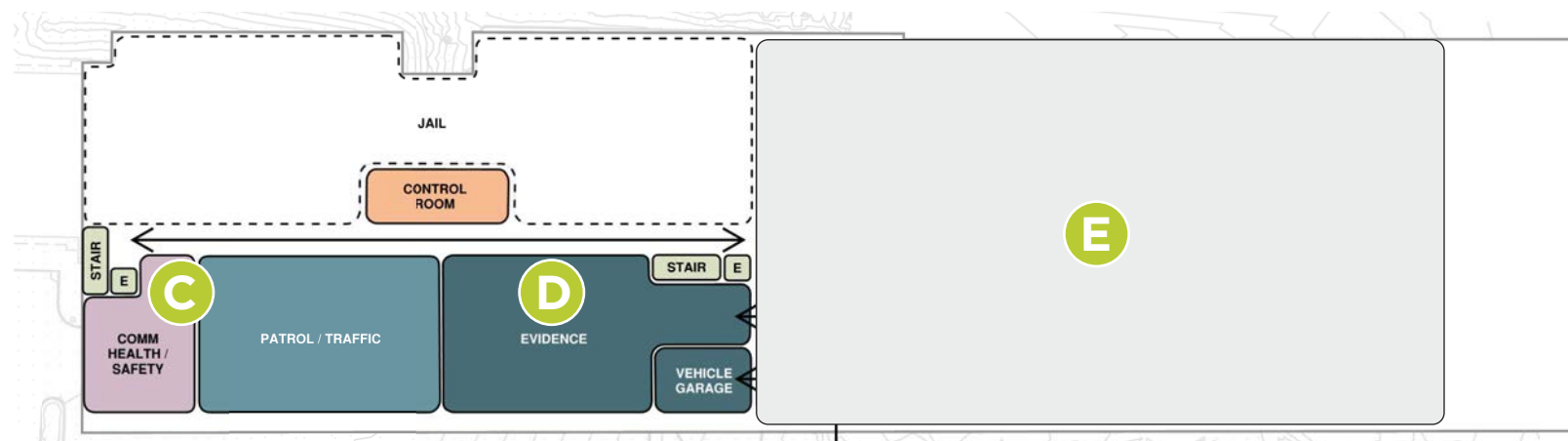

LEVEL 2

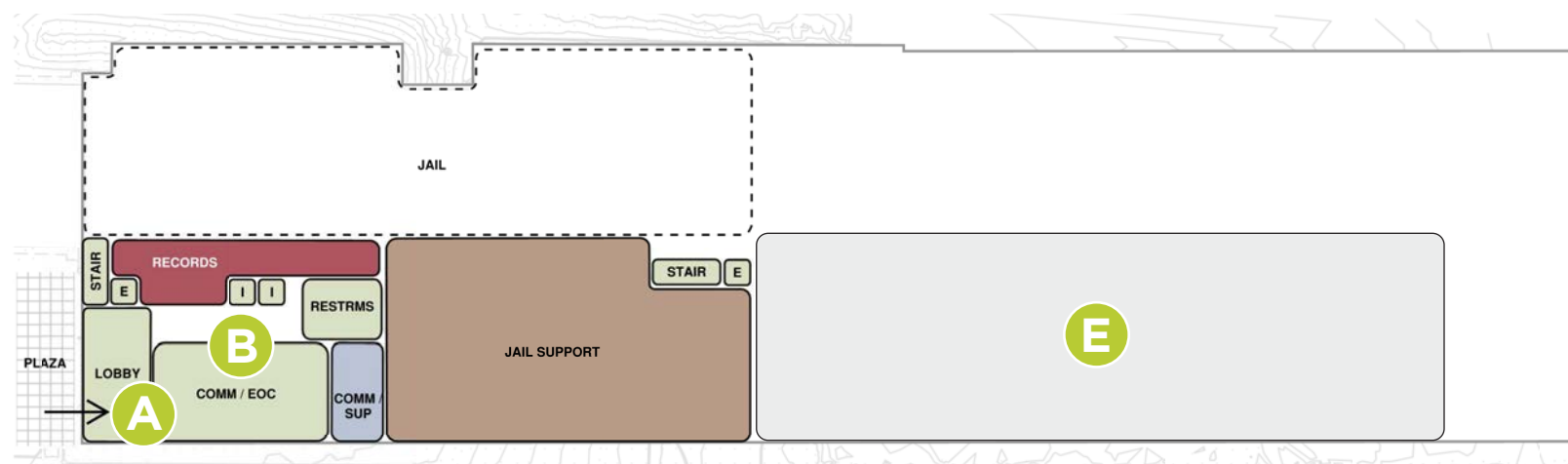

LEVEL 1

- A** | Dedicated Police Lobby Services
- B** | Community Room / Emergency Operations Center (EOC)
- C** | Expanded Community Health Services
- D** | Onsite Evidence Storage
- E** | Dedicated Secure Parking

SITE PLAN

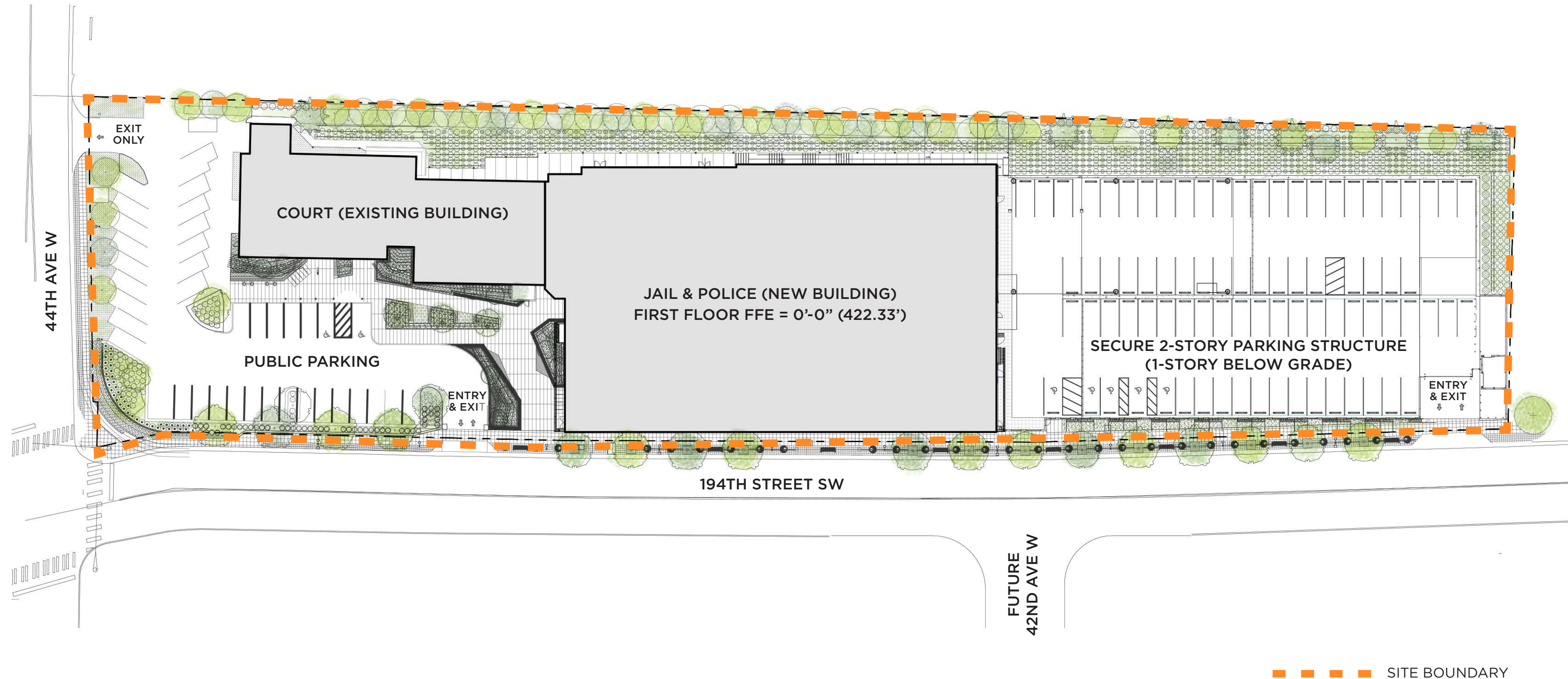



- A** | Secure Court Entry
- B** | Dedicated Police Entry
- C** | Public Art Installation(s)
- D** | City Center Frontage Improvements
- E** | Secure Parking Entry











Budget

- Total Project Budget — \$64 million
 - Hard Costs — \$45.7 million
 - Soft Costs — \$18.3 million

Thank you!

MACKENZIE.

833.317.9051 | mcknze.com

Architecture · Interiors · Structural Engineering · Civil Engineering
Land Use Planning · Transportation Planning · Landscape Architecture

Copyright © 2021 Mackenzie, All Rights Reserved.